

**LOCATION PLAN**

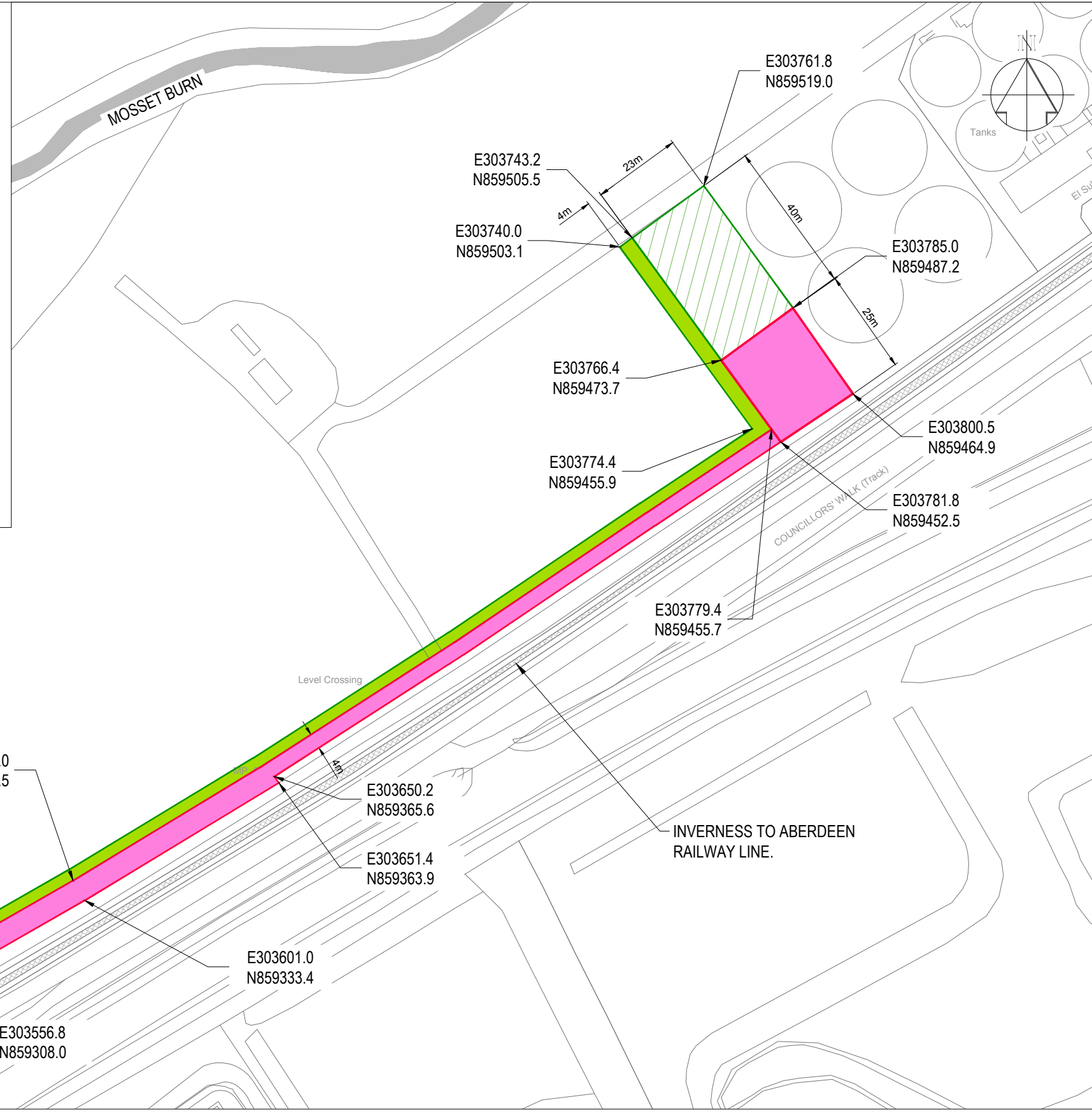

**PLAN**

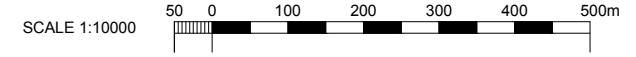
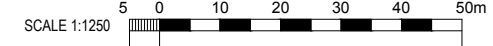

OWNER(S)	OCCUPIER(S)
CHRISTIE ELITE NURSERIES LTD. FORRES MORAY IV36 3TW	CHRISTIE ELITE NURSERIES LTD. FORRES MORAY IV36 3TW

DATE:--  
DRAWING No.:-- 5000062051-WW-DRA-04151014  
SCALE:-- AS SHOWN  
SIGNATURE.....  
ON BEHALF OF  
SCOTTISH WATER  
FAIRMILEHEAD OFFICE  
55 BUCKSTONE TERRACE  
EDINBURGH EH10 6XH

**LEGEND:**

EXTENT OF WORKING AREA (1042m²):	
TEMPORARY WORKING AREA (906m²):	
EXTENT OF PERMANENT LAND PURCHASE (1903m²):	

CONTRACTOR TO AGREE ACCESS POINTS WITH LAND OWNER

Rev	Description	Drawn	Chk'd	App'd.	Date
OF	COORDINATES REVISED	R.P.			
OE	FOR INFORMATION	C.B.	G.C.	C.D.	09.02.18
OD	FOR INFORMATION	C.B.	C.C.	C.D.	10.08.17
OC	FOR INFORMATION	C.B.	S.C.	C.D.	18.01.17
OB	FOR INFORMATION	C.B.	S.C.	C.D.	10.01.17
OA	FOR INFORMATION	C.B.	C.C.	S.C.	18.11.16

Originated By <b>C. CAREY</b>	Date 16.10.16
Drawn By <b>C. BANKS</b>	Date 16.10.16
Checked By <b>C. CAREY</b>	Date 18.11.16
Approved By <b>S. CAVANAGH</b>	Date 18.11.16



SCOTTISH WATER  
CASTLE HOUSE  
6 CASTLE DRIVE  
CARNEGIE CAMPUS  
DUNFERMLINE  
FIFE KY11 8GG  
TEL: 0800 0778778



THE BRIDGE  
BUCHANAN GATE BUSINESS PARK  
CUMBERNAULD ROAD, STEPPS, GLASGOW. G33 6FB  
This drawing is the property of Scottish Water and must not be copied or used for any purpose other than that for which it is supplied without the written consent of Scottish Water.

Project Title <b>FORRES WWTW</b>
Drawing Title <b>LAND ACQUISITION PLAN</b>

Status <b>FOR INFORMATION</b>
Scale <b>AS SHOWN</b>
ELLIPSE EQUIPMENT No.
ELLIPSE PLANT No.
Drawing No. <b>5000062051-WW-DRA-04151014-0F</b>